



## Type 2071A Commercial Gauges



### FEATURES

- *Aluminum back flanged case (black) with attractive chrome-plated steel ring*
- *Adjustable pointer as standard*
- *ASME B40.100, Grade A accuracy ( $\pm 2-1-2\%$ )*

The tradition of providing accurate, distinctive, reliable pressure instruments continues in Ashcroft 4½" Type 2071A commercial gauges.

Ashcroft 4½" Type 2071A, Contractor gauges, are constructed with a back flanged aluminum case, painted black, and a chrome ring with a glass window. These gauges are designed to meet the needs of heating, ventilating, plumbing and air conditioning contractors. The accuracy of these gauges is ASME B40.100, Grade A,  $\pm 2-1-2\%$ .

Incorporated in Type 2071A gauges is the PowerFlex™ movement. This movement provides superior resistance to shock, vibration, and pulsation; thereby assuring longer life for your pressure instrument.

True Zero™ indication, a standard feature on these gauges, reduces the potential risk of installing a damaged gauge on your equipment. Other benefits of this unique safety feature include reduced manufacturing and inspection costs.

**COMMONLY USED ON**  
*HVAC, plumbing applications*

### PRODUCT SPECIFICATIONS

**Ashcroft® Model No.:** 2071A

**Size:** 4½"

**Case:** Black painted aluminum with back flange

**Ring:** Chrome plated steel, friction fit

**Window:** Glass

**Dial:** Black figures on white background, aluminum

**Pointer:** Adjustable, black, aluminum

**Bourdon**

**Tube:** "C"- shaped bronze, soldered, siphon required for steam service

**Movement:** PowerFlex™ with polyester segment

**Socket:** Brass

**Connection:** ¼ NPT lower

**Ranges:** Vacuum – 600 psi and compound

**Accuracy:** ASME B40.100, Grade A,  $\pm 2-1-2\%$

**Operating**

**Temperature:** –40°F to 150°F, –40°C to 65°C

### OPTIONAL FEATURES

**Case:** Case color (other than black)

**Window:** Plastic

**Pointer:** Non-adjustable

**Socket:** Nickel plated  
Throttle plugs – 0.007, "0.013, "0.020, "0.063" orifices

**Others:** Customized dials  
Non-standard ranges  
Special calibration on application

### HOW TO ORDER (Typical example)

Dial Size: 4½" \_\_\_\_\_ 45    W    2071    A    02L    XT5    100#  
 Movement: Patented PowerFlex™ \_\_\_\_\_  
 Case Type Number: 2071 \_\_\_\_\_  
 Connection Material: Brass \_\_\_\_\_  
 Connection Size/Location: ¼ NPT Lower \_\_\_\_\_  
 Option: .013" orifice throttle plug \_\_\_\_\_  
 Range: 100 psi \_\_\_\_\_

## Type 2071A Commercial Gauges

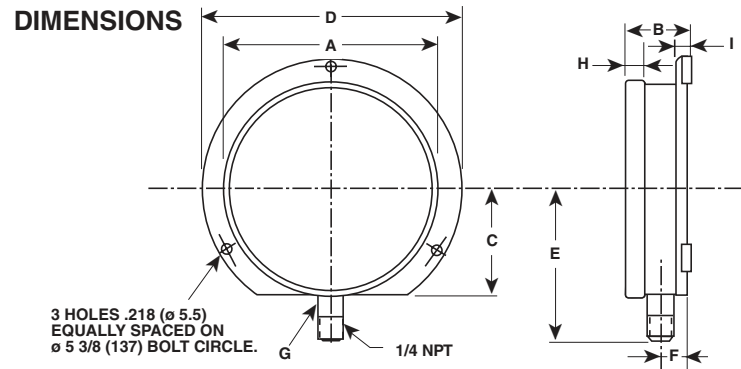

### TYPE 2071A

T-2071A 4 1/2"	A	B	C	D	E	F	Wrench Flats G	H	I	Weight
Inches	4.75	1.41	2.38	5.81	3.38	0.47	9/16	0.42	0.25	17.21 oz
(mm)	(121)	(36)	(60)	(148)	(86)	(12)	(14)	(11)	(6)	.488 kg