



LED

Explosion-proof LED Floodlight Series d9000... LED

Application:

Hazardous locations of zones 1, 2 and 21, 22, onshore and offshore installations, loading stations, oil rigs, silos etc.

Design:

Housing and glass retaining frame:

From weathering resistant cast aluminium. Operating unit located inside the housing.

Safety glass pane: Resistant to tempera-

ture variations, sealed into the frame, hingeable.

Connection terminal: Standard:

L1+N+PE, clamping range: 2.5mm².

Mounting: Stainless steel bracket, infinitely swivelling around the longitudinal axis of the floodlight.

Technical data:

LED: Highpower LED, typically ca.5.000K, colour reproduction typically R_a75, shelf life L₉₅ B₁₀ > 50.000h (at max. ambient temperature).

Light control: LED optics with narrow (LOM) or narrow/wide (LOWW) beaming characteristics.

Options:

- wide range voltage 120-277V AC
- clamping range up to 6mm²
- 2 cable glands for cable looping
- grid

- for ambient temperatures from -50°C up to +40°C/+50°C/+60°C (as per technical version)
- hard coating

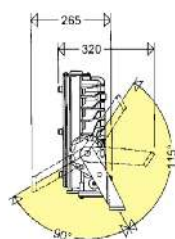
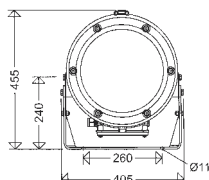
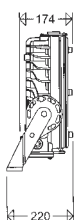
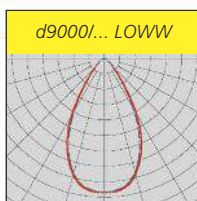
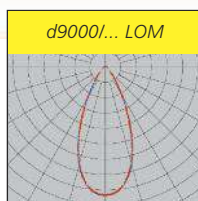

Swivel range: ± 90°

SCHUCH Quality - your advantage:

- fully adequate substitute for a 250W HI-projector (type d9000/4204)
- energy cost saving up to 45% realisable
- applicable in a wide temperature range from -20°C to +40°C (on demand from -50°C to +60°C depending on version)
- instant light with maximum luminous flux even at very low temperatures (increased luminous flux)
- housing and glass retaining frame made out of an excellent quality copper-free aluminium alloy (British Standard Marine Grade BS EN 13195) without additional painting or coating, also applicable in rough offshore installations
- quality highpower LED for maximum light performance
- optimal thermal management possible by direct connection from the LED to the housing, large cooling surface, excellent thermal conductivity
- ECG with high over voltage protection, fail-safe by overload, short-circuit and excess temperature protection
- can be supplied for voltages from 120V to 277V
- homogeneous and effective light distribution by specially calculated lens optics
- resistant against vibrations and shakings
- infinitely adjustable tilt angle
- almost maintenance-free operation due to long service life of the LED

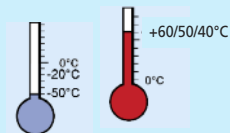

Notes:

Limitations for LED-light fittings: See chapter „Use of LED lighting in corrosive atmospheres“ in the Technical Appendix.

All technical data is relevant at the time of print. Actual technical data can be found in the internet under www.schuch.de.



d9000 ...



II 2 G Ex d e op is IIC T4/T6 Gb

II 2 D Ex tb IIIC T80°C Db

IP66/67



EC-Type Examination Certificate:

PTB12 ATEX 1030

Other approvals:

IECEX PTB12.0057

Marking:

II 2 G Ex d e op is IIC T4/T6 Gb (Zone 1)

II 2 D Ex tb IIIC T80°C Db (Zone 21)

Ignition protection: d (flameproof)

Ambient temperature:

–20°C up to +40°C, –50°C up to

+50/60°C depending on version

on demand

Rated voltage: 220V - 240V AC,

50/60Hz, 120V - 277V AC upon request.

Type	Article no.	Temperature class	Power/ consumption W	Luminous flux lm	Luminous efficacy lm/W	Previous lamps	Weight ca. kg ¹⁾
narrow beam							
d9000/4201 LOM	89000 0001	T6	47	4.400	92	HST70/HIE150/HME250	16,8
d9000/4203 LOM	89000 0002	T6	94	7.700	86	HST150	16,8
d9000/4204 LOM	89000 0003	T4	140	10.200	76	HIT250/HSE250	16,8
narrow-wide beam							
d9000/4201 LOWW	89000 0004	T6	47	4.400	92	HST70/HIE150/HME250	16,8
d9000/4203 LOWW	89000 0005	T6	94	7.700	86	HST150	16,8
d9000/4204 LOWW	89000 0006	T4	140	10.200	76	HIT250/HSE250	16,8

1) Weights without packing material

Explosion protected
Light Fittings Zone 1



THORNE &
DERRICK
INTERNATIONAL

Thorne & Derrick
+44 (0) 191 410 4292
www.heatingandprocess.com

Accessories / Spare Parts

Type	Article no.	
Cable entries / Cable glands		
2537	90117 9000	Ex-protected plastic cable gland M25 x 1,5
2538	90118 9000	Ex-protected plastic plug M25 x 1,5