

WELLGLASS

EV.. Series well glass lighting fixture for halogen and fluorescent lamps



EV.. series well glass lighting fixtures are suitable for hazardous areas of industrial plants for lighting of indoor and outdoor structures, for which narrow or wide beam lighting is needed.

These luminaries have been designed to house energy saving lamps; light source can be driven where required by way of suitable reflectors.

EV.. luminaries, provided in a wide range of wattage, have an excellent corrosion resistance due to the body made of aluminium with low content of copper and tempered glass of lamp compartment.

TECHNICAL FEATURES

Material	Aluminium with low content of copper
IP rating	IP66
Ambient temperature range	-52°C to +60°C
Approvals	Certified 01ATEX0019X (standard) IECEX INE 15.0031X CoC TR CU 012/2011 (marking upon request, ordering code to be required)
Marking	II 2 GD Ex d IIC T(**) Gb for all EV.. Ex de IIC T(**) Gb for all EVde.. Ex tb IIIC T(**) Db IP66 ** T5/T100°C, T4/T135°C, T3/200°C
Gaskets	O-ring made of Nitrile Rubber (NBR)
Surface treatment	Green colour polyurethane painting cycle RAL6003 (other colour available upon request)
Entries	N° 2 entries M25x1,5 (EVde and EVCC version) N° 1 entry M25x1,5 (EVA version) (plugs and cable glands excluded)
Hardware and screws	AISI304 Stainless steel external hardware and screws
Lamps	Included
Rated operation voltage (UE)	HALOGEN LAMPS 230V (standard) 220V, 240V (upon request) FLUORESCENT LAMPS 220/240V
Frequency	50/60 Hz
Accessories available upon request	Protection guard Reflector Pole mounting kit (EVde version)

Dimensions EVde

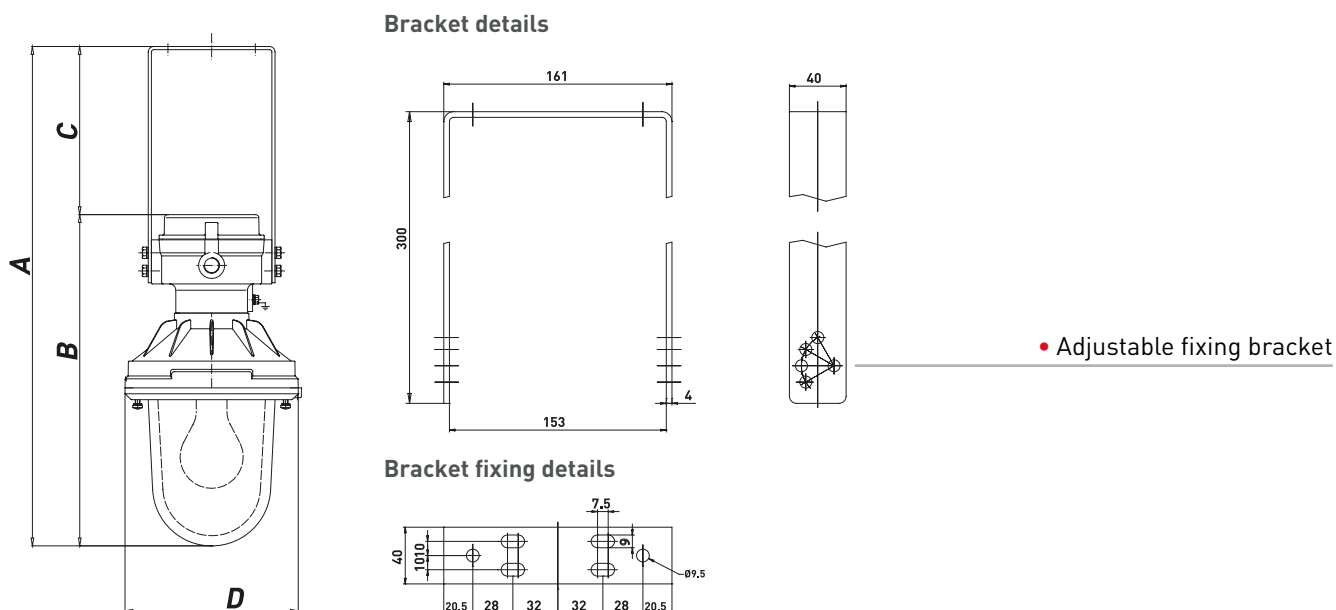

EVde well glass lighting fixtures

EVde version, with integrated Ex e junction box, allows end users and contractors the possibility to save one junction box, two cable glands and a minimum of 30 minutes of labour during installation process.

This version is supplied complete with an adjustable AISI304 stainless steel mounting bracket suitable for ceiling, wall and suspension installation.

(HA) Halogen – Energy saving

TYPE	CODE	LAMP [W]	WEIGHT [Kg]	TEMP. CLASS	DIMENSIONS [mm]			
					A	B	C	D
EVDE-1/HA 42	A044111E2171D	42 [OLD 60W INC.]	2.90	T4*	505	291	214	146
EVDE-2/HA 42	A044121E21714	42 [OLD 60W INC.]	3.10	T3**	550	336	214	163
EVDE-2/HA 70	A044121H01714	70 [OLD 100W INC.]	3.10	T3**	550	336	214	163
EVDE-2/HA 105	A0441211A1714	105 [OLD 150W INC.]	3.10	T3**	550	336	214	163
EVDE-3/HA 105	A0441311A1714	105 [OLD 150W INC.]	4.40	T3**	584	370	214	194
EVDE-4/HA 140	A04414114171D	140 [OLD 200W INC.]	7.00	T4	635	421	214	220
EVDE-5/HA 200	A044151201714	200	9.00	T3***	715	501	214	281

*In case of maximum ambient temperature reaches +40°C , temperature class changes into T5 [ordering code to be required]

**In case of maximum ambient temperature reaches +55°C , temperature class changes into T4 [ordering code to be required]

***In case of maximum ambient temperature reaches +40°C , temperature class changes into T4 [ordering code to be required]

(FC) Fluorescent compact – Energy saving long life (8000h)

TYPE	CODE	LAMP [W]	WEIGHT [Kg]	TEMP. CLASS	DIMENSIONS [mm]			
					A	B	C	D
EVDE-2/FC 26	A045121C6171D	26	3.10	T4*	550	336	214	163
EVDE-3/FC 45	A045131E5171D	45 [OLD 200W INC.]	4.40	T4*	584	370	214	194
EVDE-4/FC 45	A045141E5171D	45 [OLD 200W INC.]	7.00	T4**	635	421	214	220
EVDE-5/FC 45	A045151E5171D	45 [OLD 200W INC.]	9.00	T4**	715	501	214	281

*In case of maximum ambient temperature reaches +40°C , temperature class changes into T5 [ordering code to be required]

**In case of maximum ambient temperature reaches +40°C , temperature class changes into T6 [ordering code to be required]

In case of maximum ambient temperature reaches +55°C , temperature class changes into T5 [ordering code to be required]

Notes:

- Below -20°C, the fluorescent compact light can be used, providing they are switched on 24 hours a day

Dimensions EVCC

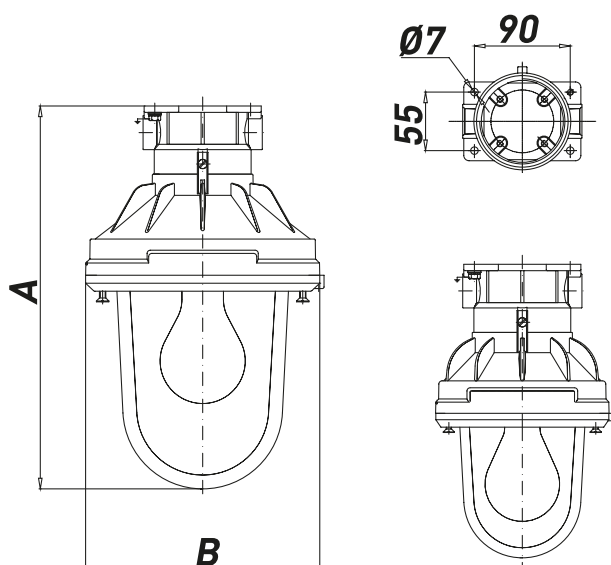

EVCC well glass lighting fixtures

EVCC version, without integrated Ex e junction box, allows standard ceiling installation.

(HA) Halogen – Energy saving

TYPE	CODE	LAMP [W]	WEIGHT [Kg]	TEMP. CLASS	DIMENSIONS [mm]	
					A	B
EVCC-1/HA 42	A044211E2171D	42 (OLD 60W INC.)	2.40	T4*	230	146
EVCC-2/HA 42	A044221E21714	42 (OLD 60W INC.)	2.60	T3**	276	162
EVCC-2/HA 70	A044221H01714	70 (OLD 100W INC.)	2.60	T3**	276	162
EVCC-2/HA 105	A0442211A1714	105 (OLD 150W INC.)	2.60	T3**	276	162
EVCC-3/HA 105	A0442311A1714	105 (OLD 150W INC.)	3.90	T3**	309	194
EVCC-4/HA 140	A04424114171D	140 (OLD 200W INC.)	6.50	T4	360	220
EVCC-5/HA 200	A044251201714	200	8.50	T3***	440	281

*In case of maximum ambient temperature reaches +40°C , temperature class changes into T5 (ordering code to be required)

**In case of maximum ambient temperature reaches +55°C , temperature class changes into T4 (ordering code to be required)

***In case of maximum ambient temperature reaches +40°C , temperature class changes into T4 (ordering code to be required)

(FC) Fluorescent compact – Energy saving long life (8000h)

TYPE	CODE	LAMP [W]	WEIGHT [Kg]	TEMP. CLASS	DIMENSIONS [mm]	
					A	B
EVCC-2/FC 26	A045221C6171D	26	2.60	T4*	276	162
EVCC-3/FC 45	A045231E5171D	45 (OLD 200W INC.)	3.90	T4*	309	194
EVCC-4/FC 45	A045241E5171D	45 (OLD 200W INC.)	6.50	T4**	360	220
EVCC-5/FC 45	A045251E5171D	45 (OLD 200W INC.)	8.50	T4**	440	281

*In case of maximum ambient temperature reaches +40°C , temperature class changes into T5 (ordering code to be required)

**In case of maximum ambient temperature reaches +40°C , temperature class changes into T6 (ordering code to be required)

In case of maximum ambient temperature reaches +55°C , temperature class changes into T5 (ordering code to be required)

Notes:

- Below -20°C, the fluorescent compact light can be used, providing they are switched on 24 hours a day

Dimensions EVA

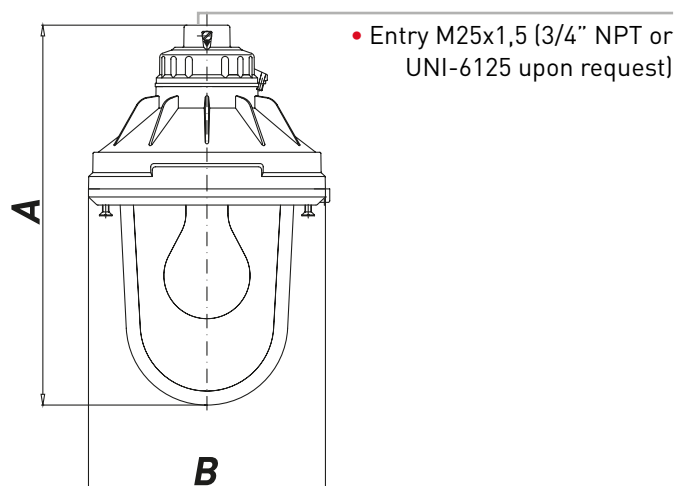

EVA well glass lighting fixtures

EVA version, without integrated Ex e junction box, allows standard suspension installation by conduit system and pastoral pole.

(HA) Halogen – Energy saving

TYPE	CODE	LAMP [W]	WEIGHT [Kg]	TEMP. CLASS	DIMENSIONS [mm]	
					A	B
EVA-1/HA 42	A044311E2171D	42 (OLD 60W INC.)	2.40	T4*	230	146
EVA-2/HA 42	A044321E21714	42 (OLD 60W INC.)	2.60	T3**	276	162
EVA-2/HA 70	A044321H01714	70 (OLD 100W INC.)	2.60	T3**	276	162
EVA-2/HA 105	A0443211A1714	105 (OLD 150W INC.)	2.60	T3**	276	162
EVA-3/HA 105	A0443311A1714	105 (OLD 150W INC.)	3.90	T3**	309	194
EVA-4/HA 140	A04434114171D	140 (OLD 200W INC.)	6.50	T4	360	220
EVA-5/HA 200	A044351201714	200	8.50	T3***	440	281

*In case of maximum ambient temperature reaches +40°C , temperature class changes into T5 (ordering code to be required)

**In case of maximum ambient temperature reaches +55°C , temperature class changes into T4 (ordering code to be required)

***In case of maximum ambient temperature reaches +40°C , temperature class changes into T4 (ordering code to be required)

(FC) Fluorescent compact – Energy saving long life (8000h)

TYPE	CODE	LAMP [W]	WEIGHT [Kg]	TEMP. CLASS	DIMENSIONS [mm]	
					A	B
EVA-2/FC 26	A045321C6171D	26	2.60	T4*	276	162
EVA-3/FC 45	A045331E5171D	45 (OLD 200W INC.)	3.90	T4*	309	194
EVA-4/FC 45	A045341E5171D	45 (OLD 200W INC.)	6.50	T4**	360	220
EVA-5/FC 45	A045351E5171D	45 (OLD 200W INC.)	8.50	T4**	440	281

*In case of maximum ambient temperature reaches +40°C , temperature class changes into T5 (ordering code to be required)

**In case of maximum ambient temperature reaches +40°C , temperature class changes into T6 (ordering code to be required)

In case of maximum ambient temperature reaches +55°C , temperature class changes into T5 (ordering code to be required)

Notes:

- Below -20°C, the fluorescent compact light can be used, providing they are switched on 24 hours a day