

EVO is a safety multipolar switch-disconnector with rotary manual control for making/breaking on-load and safety isolation of LV electrical circuits.

It is composed of two separable parts, in individual enclosures:

- An enclosure on the 'supply' side (supply part), and
- An enclosure on the 'load' side (load part).



EVO allows the replacement of failed equipment without specific qualification in a minimum time, without uncabing or disconnecting the power from the supply.

Two stabilized positions OFF / ON which are obtained by rotation from one part to the other one.

- Double snap breaking and fully visible breaking on each of the 6 poles,
- Visible breaking by separation of the two parts,
- Manual operation independent of the action of the operator.

EVO can be locked in OFF or ON position.

EVO complies with the following regulations and standards(a):

- European Regulation REACH,
- European Directives Low Voltage and RoHS (affixing of the CE marking),
- Standards IEC/EN 60947-1, IEC/EN 60947-3.

The use of EVO facilitates compliance of:

- electrical machinery to the "Machinery" European Directive on isolating device, and to standard EN 60204-1 : Safety of machinery – electrical equipment of machines
- electrical installations:

- * to national regulations relating to the improvement of the safety and health of workers at work in France, Italy, Spain, Belgium,
- * to installation standards: IEC 60364 (international), HD 60364 (European) and NF C 15-100 (French) or other national transposition of IEC/HD 60364.



General information

P_{max}	18.5 kW
(b) I_{the}	40 A
U_{max}	690 V AC
(c) Frequency (Hz)	≤ 500
(d) Number of contacts	6P+E
Connection (min - max): mm ²	
Flexible conductors (Cu): main contacts	2.5 - 10
Rigid/stranded conductors (Cu): main contacts	2.5 - 16
Tightening torque - main contacts	1.8 Nm
Wiring lugs	Option
Icc: conditional short circuit current (kA)	
with gG or aM fuse	100 kA
Icm: short-circuit making capacity	1 kA
Ui: rated insulating voltage	1 kV AC
Uimp: impulse withstand voltage	8 kV AC

Breaking as switch according to IEC/EN 60947-3

Category AC-22A: In (A) - Umax (V AC)	40 - 690
	250 - 11
Category AC-23A: Umax (V AC) - P (kW)	400 - 18.5
	690 - 18.5
	250 - 7.5
Category AC-3: Umax (V AC) - P (kW)	400 - 11
	690 - 11

Number of operations

(e) According to IEC/EN 61947-3: in service operation AC-23A	15 000
---	--------

Isolating distance

10 mm

Thermal features

Temperature of use mini/maxi (°C)	-25/+60 °C
Storage temperature mini/max: (°C)	-40/+80 °C
Maximal temperature rise (Kmax)	25 K
Time constant (to reach 63 % of Kmax)	18 mn

Connection of supply cable

EVO Supply part

EVO Load part

Connection of flexible load cable

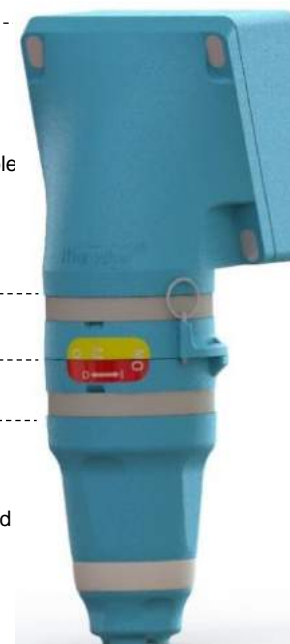

Mechanical features

- (f) IP: connected device
- (f) IP: lid/cap closed
- (f, g) IP: Supply part without cap (safety shutter)

- (h) IK
Retaining/releasing device
- (i) Casing

Standard color

Resistance to chemical agents
Protection against UV (according to UL 746C or equivalent)
Salt mist resistance
Screws and bolts
Weight of load part without accessory (≈)
Weight of supply part without accessory (≈)

Main options

- Supply part cap
- Load part cap
- (i) Locking / padlocking

Mounting accessories

Flush mounting on electrical cabinet
Poly sleeve: angle (°)
Poly box: angle (°)
Poly straight handle with built-in cable gland: range take (mm)

Spare parts

Gaskets

[Catalog: Web link](#)

EVO40

IP66/IP67/IP69
IP66/IP67/IP69
IP4X - Safety shutter

IK09
Detent pin
GRP (poly)
MARECHAL® Blue
Contact us
f1

> 50 000 h
Stainless steel
0.23 kg
0.41 kg

Included
✓
Included for OFF/ON
Red locking key

✓

[Click !](#)

EVO Load part

EVO Supply part



Dimensions

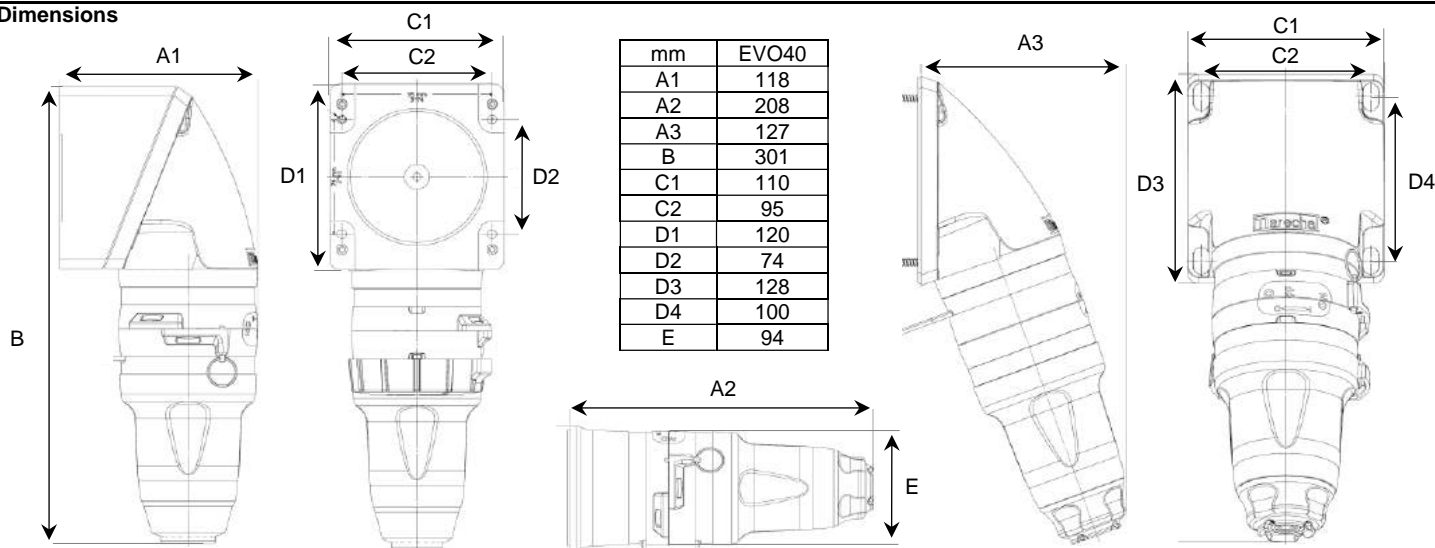

- (a) European Regulation REACH: registration, evaluation, authorisation and restriction of chemicals
IEC/EN 60947-1 : "Low-voltage switchgear and controlgear – Part 1: General rules"
IEC/EN 60947-3 : "Low-voltage switchgear and controlgear – Part 3: Switches, disconnectors, switch-disconnectors and fuse-combination units"
- (b) Ithe : Conventional enclosed thermal current (IEC/EN 60947-1)
- (c) Other frequency: contact us
- (d) Contacts with silver-nickel tips (Ag/Ni 85/15)
- (e) Double breaking of poles by self-cleaning contacts with snap switch-on and switch-off
- (f) IP : Degrees of protection provided by enclosures (IEC/EN 60529)
- (g) Live contacts are not accessible
- (h) IK : Degrees of protection provided by enclosures against mechanical impacts (IEC/EN 62262)
- (i) GRP : Glass-reinforced technical plastic
- (j) The locking in ON position requires to remove a breakaway piece
The red key is used to lock the device. Additional keys: contact us