

SAFE-GROUND SG/E-CR1/65 CABLE REEL

General data sheet

Scope

Safe-Ground CR1/65 cable reel for use with Safe-Ground earthing clamps has been specially developed to provide an effective, low-resistance connection between movable objects and the Safe-Ground earth control units, to safely divert any static electricity.

The cable reel is a component of a StuvEx earthing system and can be combined with any of the control units and clamps of the Safe-Ground product range.

Benefits

Specially developed for the Safe-Ground earthing systems, the cable reel offers the following advantages:

- ◆ High mechanical protection of the cable
- ◆ Simple and quick installation
- ◆ Minimum resistance (< 10 Ohm)
- ◆ Closed housing with earth connection
- ◆ Integrated retractor
- ◆ Cable routing with self-lubricating rollers
- ◆ Automatic blocking mechanism
- ◆ Swiveling bracket in stainless steel
- ◆ Both for indoor and outdoor use
- ◆ Suitable for use in ATEX environment (zone 1, 2, 21 and 22)

Operation

The Safe-Ground CR1/65 cable reel is equipped with brass slip rings and special brushes, so that a minimum impedance is guaranteed. As part of the StuvEx earthing control system, an effective, low-resistance (< 10 Ohm) and continuous connection is realized in this way, fully in accordance with IEC/TS 60079-32-1.

High ease of use for winding and unwinding the cable is achieved by a cable guide with self-lubricating rollers. A blocking mechanism provides a stop every 50 cm. In addition, the cable reel is equipped with a winding mechanism so that the cable is wound automatically after use. The pivoting bracket provides a wide range of use.

The cable reel is suitable for use in both an industrial environment and an ATEX environment.



SAFE-GROUND SG/E-CR1/65 CABLE REEL

Technical data sheet

Application

Safe-Ground CR1/65 cable reel for use with Safe-Ground earthing clamps has been specially developed to provide an effective, low-resistance connection between movable objects and the Safe-Ground earthing control units, to safely divert any static electricity.

The cable reel is a component of a StuvEx earthing system and can be combined with any of the control units and clamps of the Safe-Ground product range.

General characteristics

Housing	Aluminium, gray
Swiveling bracket	Stainless steel, AISI 304
Cable type	H05VV-F 2 x 1,5 + 1,5 mm ²
Core insulation	PVC, black
Length	15 m
Connection	1,7 m
Temperature	-5°C to +50°C
Humidity	95% relative humidity at 20°C, non-condensing
Degree of protection	IP65
Weight	10 kg
ATEX information	Suitable for use in zones 1, 2, 21 and 22
	II 2G Ex ia IIC T6 Gb
	II 2D Ex ia IIIC T85°C Db

Delivery

SG/E-CR1/65	Cable reel in closed housing
	Brass slip rings and special brushes for minimal resistance
	Retractor with cable guide
	Automatic blocking mechanism
	Swiveling bracket
	Earth connection
	Connector (F) mounted



SAFE-GROUND SG/E-CR1/65 CABLE REEL

Technical data sheet

Dimensions

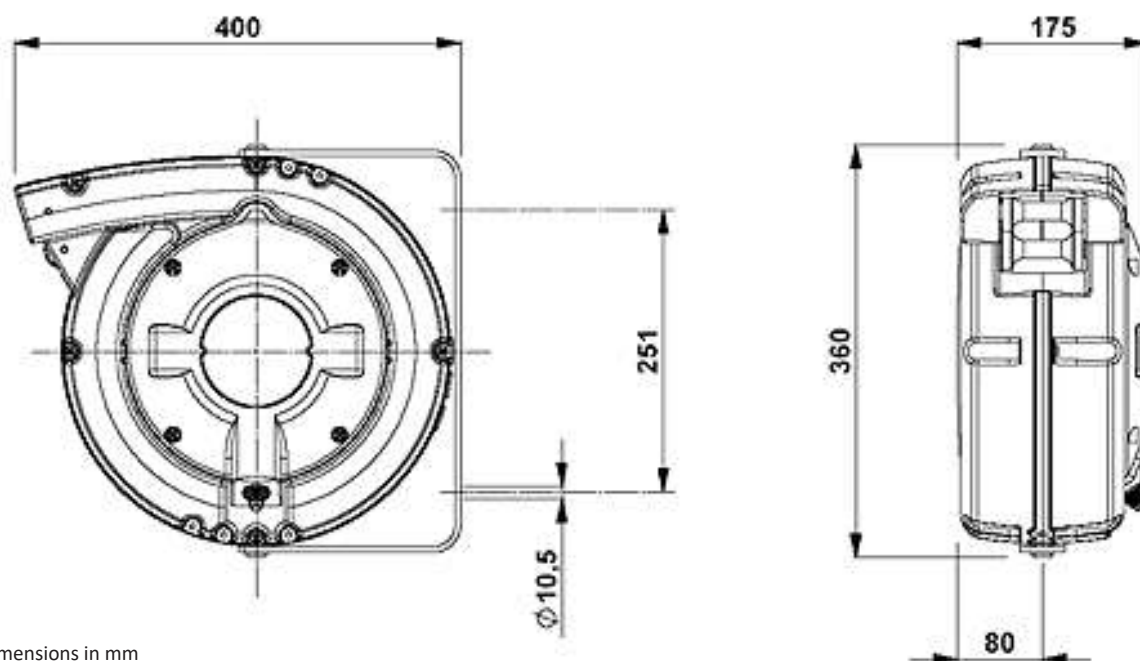

Dimensions in mm

Parts and ordering informations

Article number	Descriptions
503-3250-000	SG/E-CR1/65-N, cable reel with 15 m cable
503-3250-010	SG/E-CR1/65-15SC, cable reel with 15 m cable, pivoting bracket, cable routing, ground connection and F connector

Spare parts

Article number	Descriptions
503-3250-109	SG/E-CR1/65-BRACKET, pivoting bracket
503-3250-900	SG/E-CR1/65-RCG, cable routing
503-3250-800	SG/E-CR1/65-SB, stop ball
503-1500-000	SG/A-CONSET, set of connectors (M+F)



THORNE &
DERRICK
INTERNATIONAL

Thorne & Derrick
+44 (0) 191 410 4292
www.heatingandprocess.com